

# 88 5515 451

## Door Hutch

### IMPORTANT NOTE

Carefully remove all the parts from the carton and put them individually on a soft cloth to prevent scratches or other damages occurring to the parts.

We have taken great care in the design of this product and request that you carefully and strictly follow our assembly instructions to ensure a completed product as it was designed.

Home  
Styles

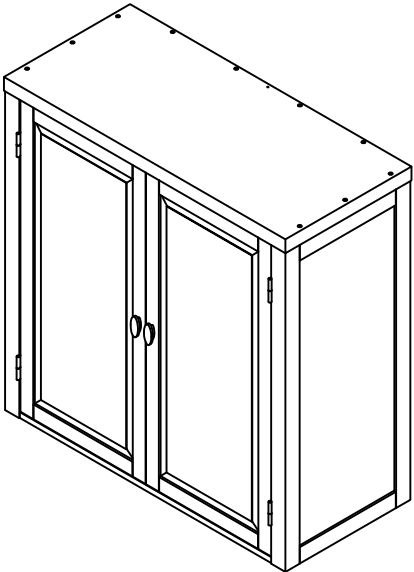

### Part List

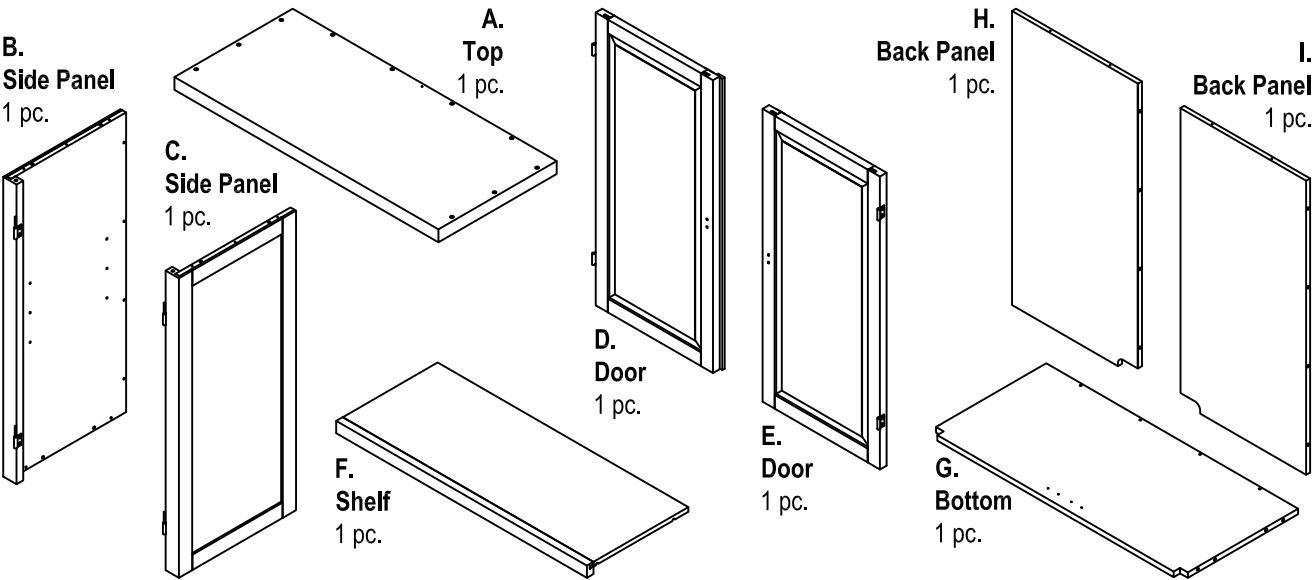

### Hardware List

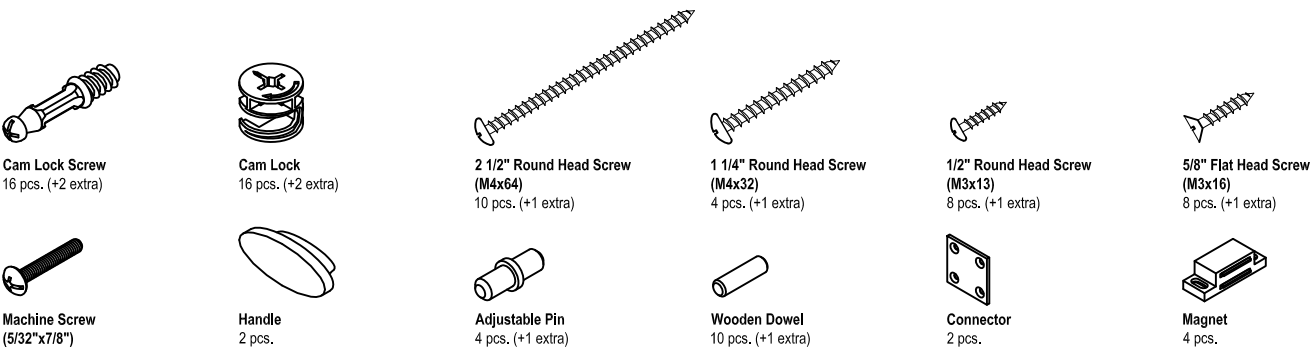

### Tipover Restraint Kit:

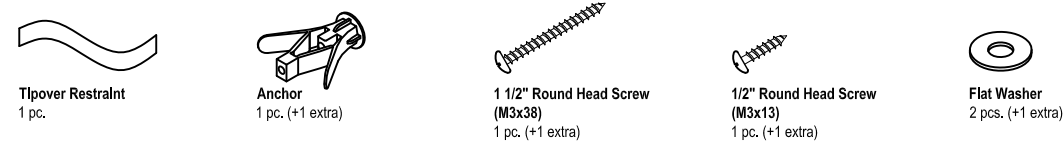

Tools Required For Assembly : Phillips screwdriver, Drill, 3/8" Drill Bit

**Home Styles Consumer Assistance:** [www.homestyles-furniture.com](http://www.homestyles-furniture.com),  
[servicedesk@homestyles-furniture.com](mailto:servicedesk@homestyles-furniture.com), 888-680-7460, 877-831-0319

**IMPORTANT**

- \* Do not tighten up all the screws until each part is properly assembled.
- \* Use a soft cloth between these parts and the floor.

**STEP 1**

Insert Cam Lock Screws into the pre-drilled holes of Side Panels (B) and (C) and Back Panel (I).

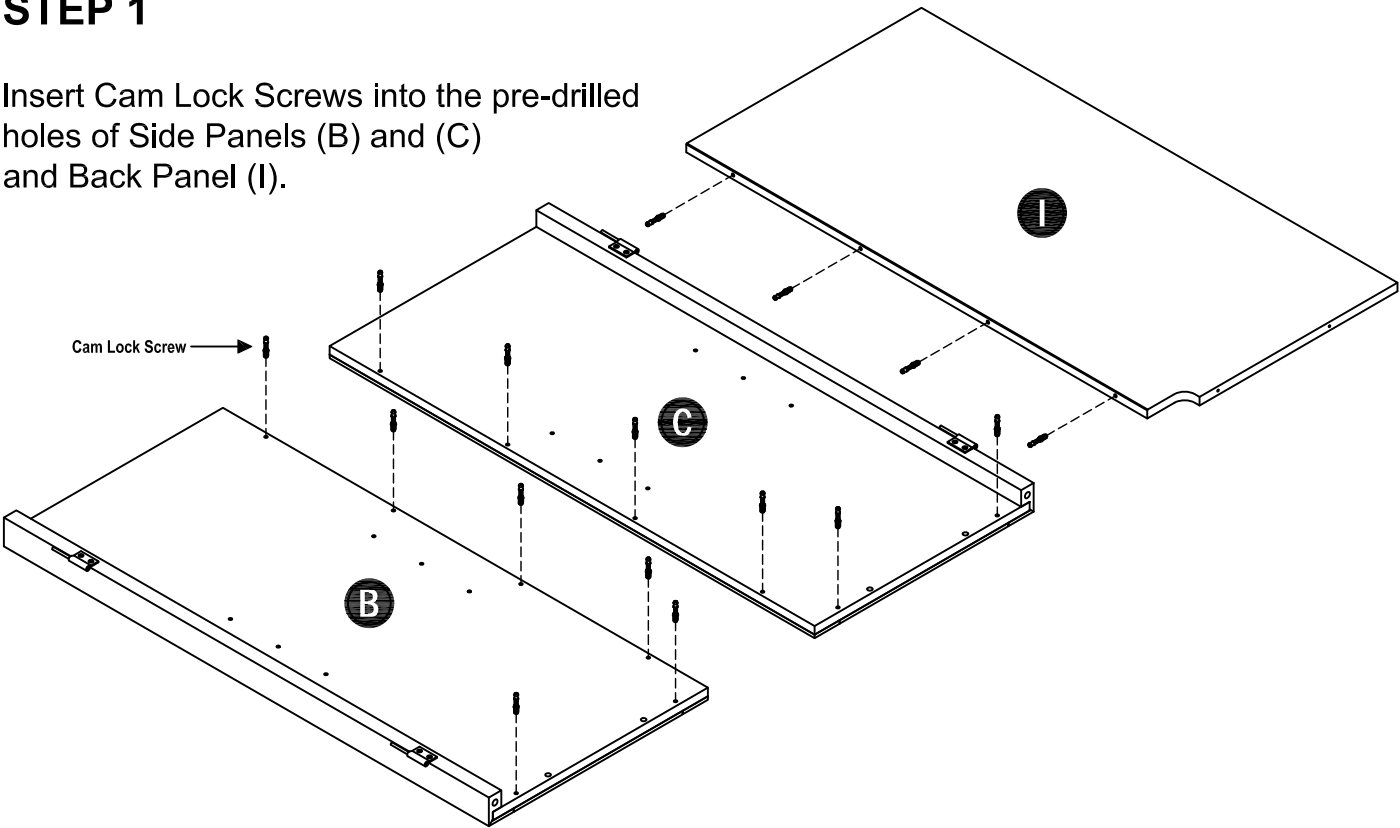

**STEP 2**

Attach Magnets to Top (A) and Bottom (G) using 1/2" Round Head Screws. (See Figure 1)

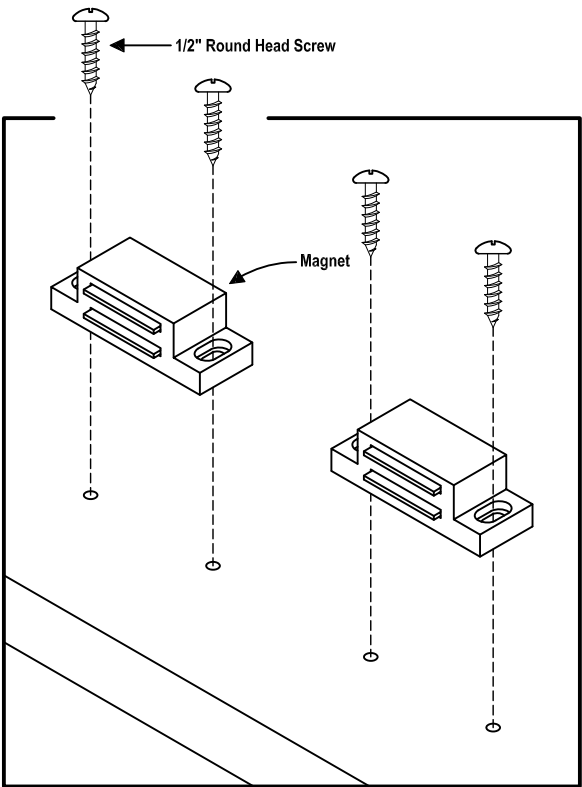
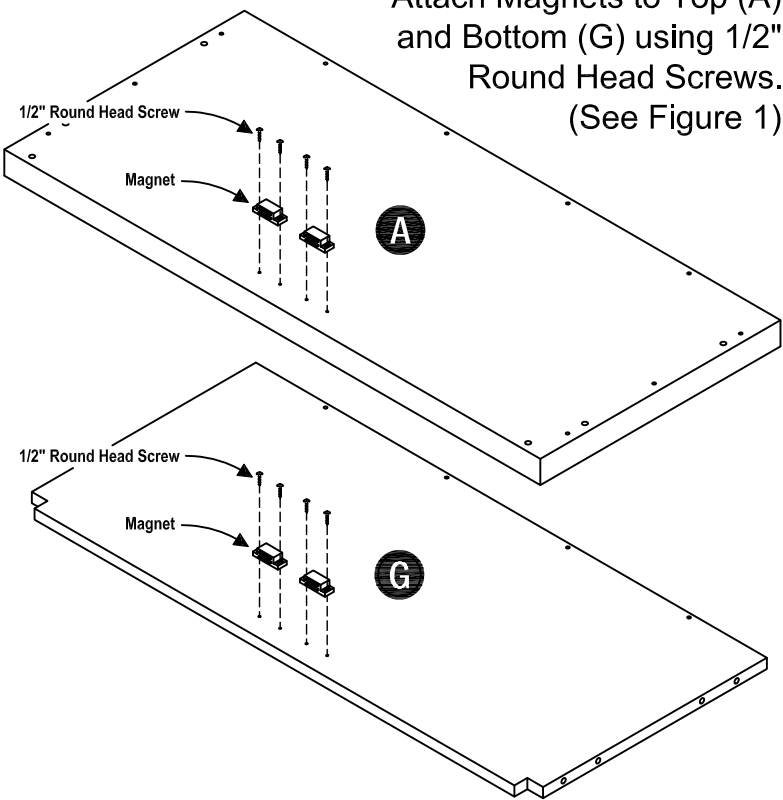

Figure 1



**STEP 3**

Attach Bottom (G) and Back Panel (I) to Side Panel (C) using Cam Locks and Wooden Dowels.  
(See Figure 2)

Attach Bottom (G) to Back Panel (I) using 1 1/4" Round Head Screws.

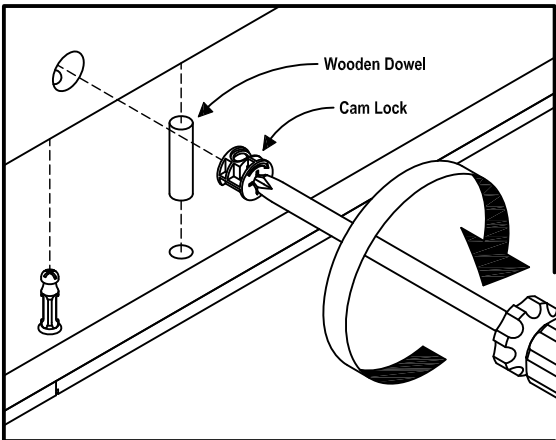
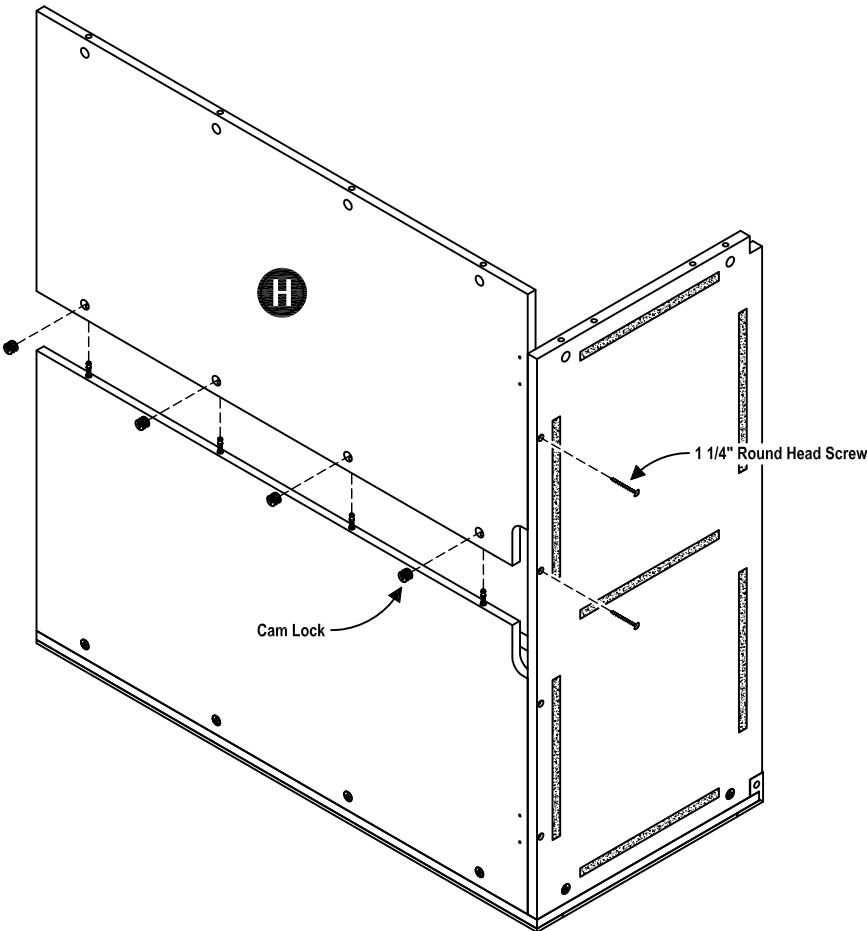
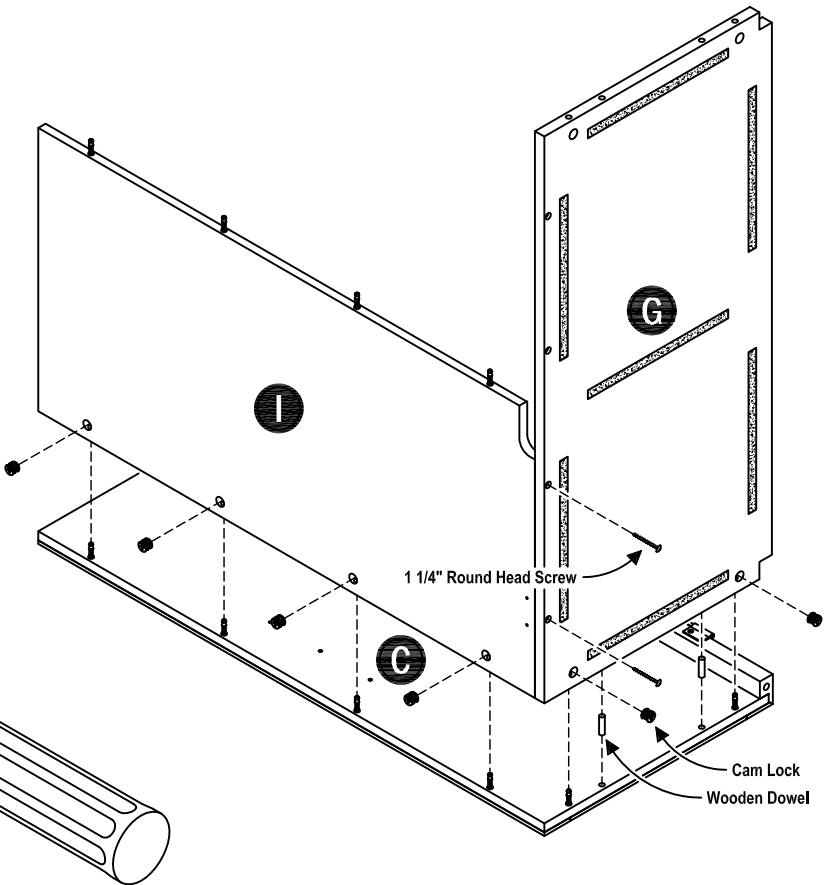

Figure 2



**STEP 4**

Attach Back Panel (H) to unit using Cam Locks and 1 1/4" Round Head Screws.

**STEP 5**

Attach Side Panel (B) to unit using Cam Locks and Wooden Dowels.

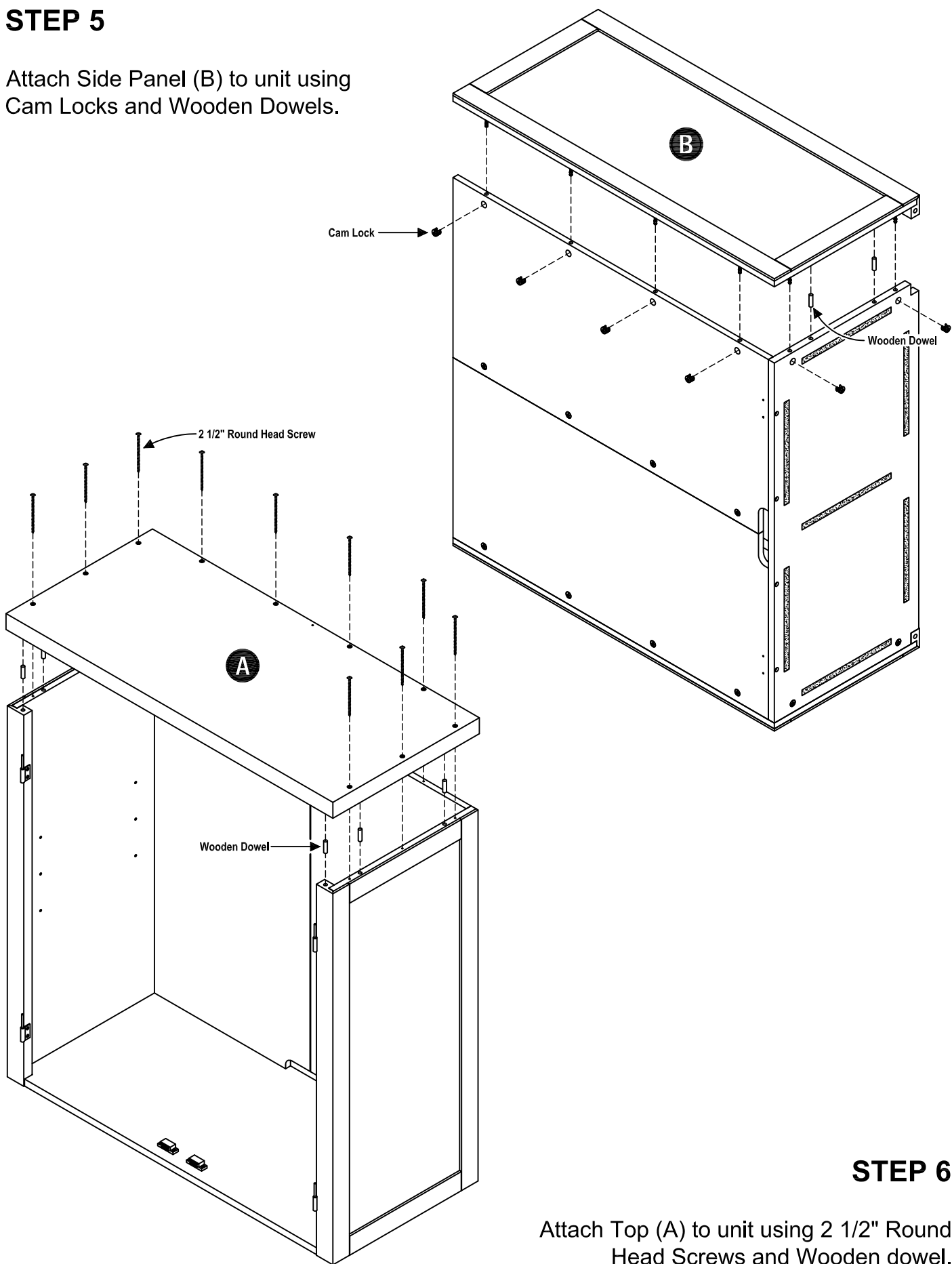

**STEP 6**

Attach Top (A) to unit using 2 1/2" Round Head Screws and Wooden dowel.

## STEP 7

Attach Handles to Doors (D) and (E) using Machine Screws.

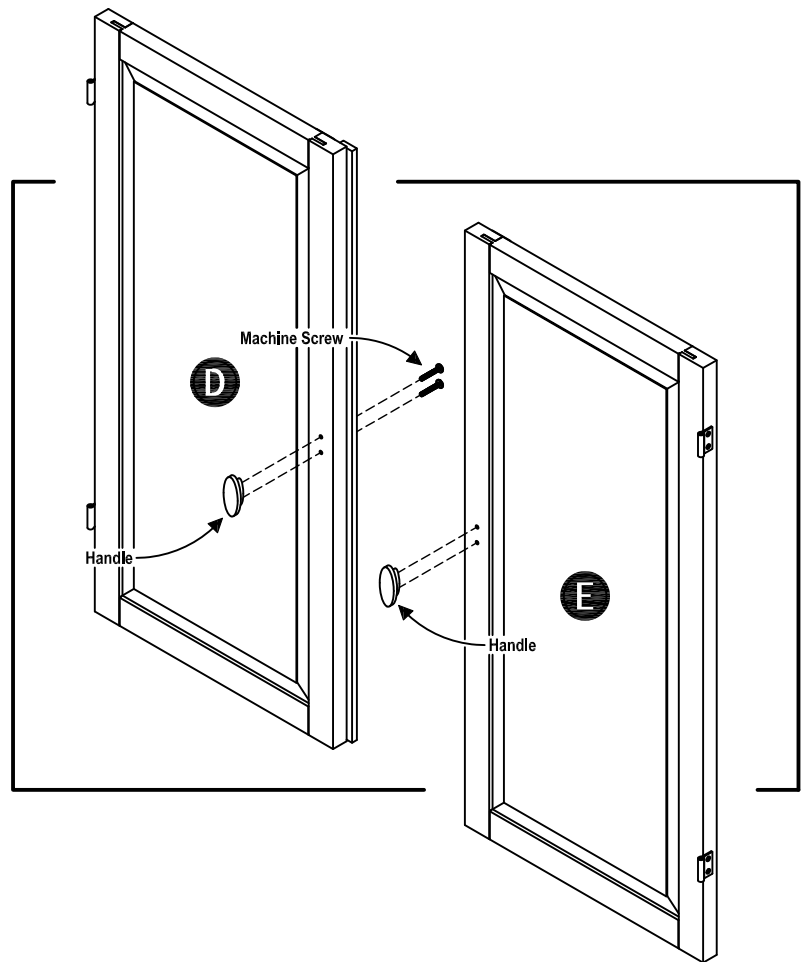

## STEP 8

Attach Doors (D) and (E) by sliding the Doors lift hinges into the Side Panels lift hinges.  
(See Figure 3)

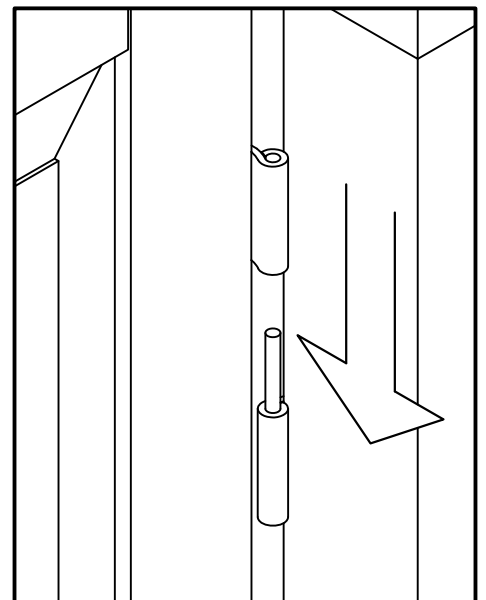
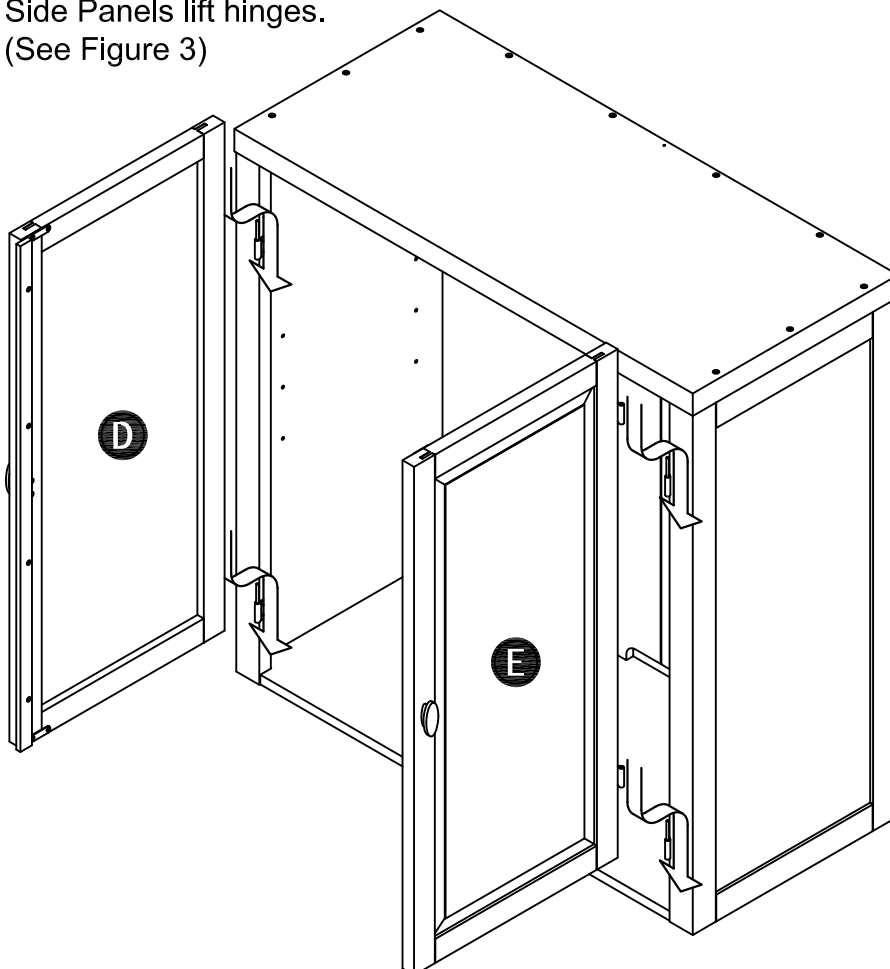

Figure 3

**STEP 9**

Insert Adjustable Pins into Side Panels at the desired level.  
(See Figure 4)

Place Shelf (F) into position.

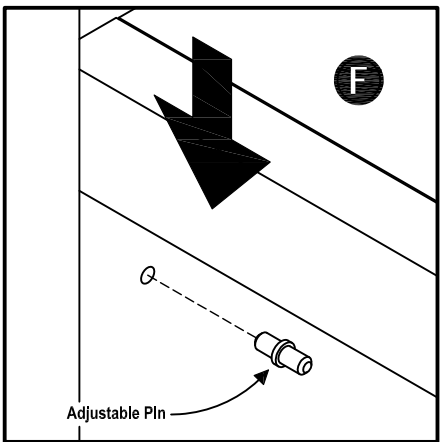
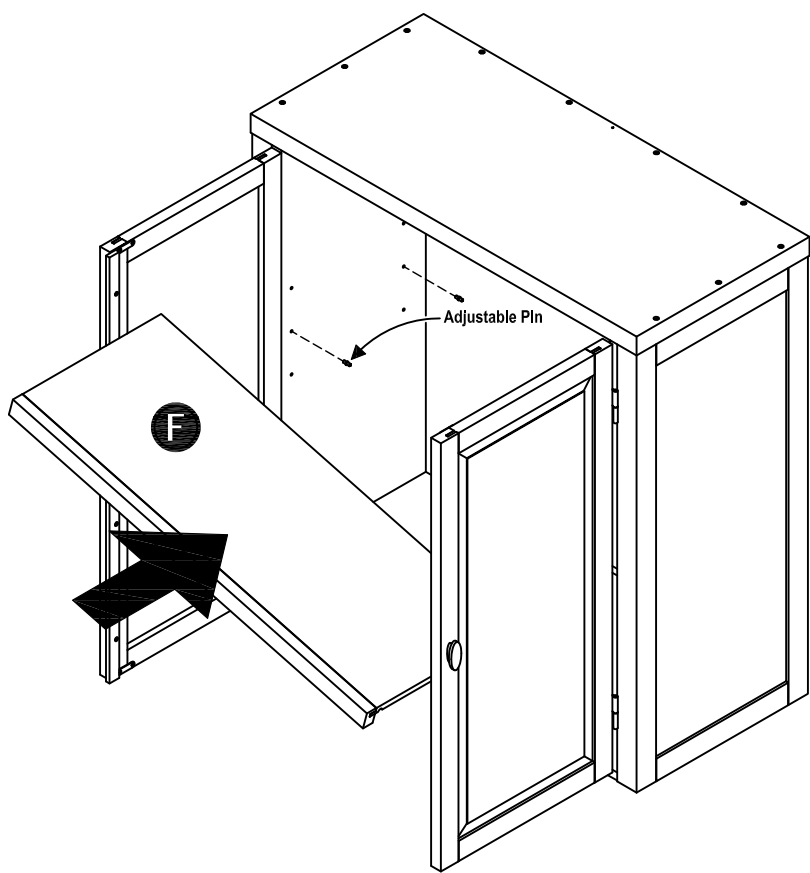

Figure 4

**STEP 10**

Place unit on 88 5515 41 Chest and attach Connectors using 5/8" Flat Head Screws to join the units.  
(See Figure 5)

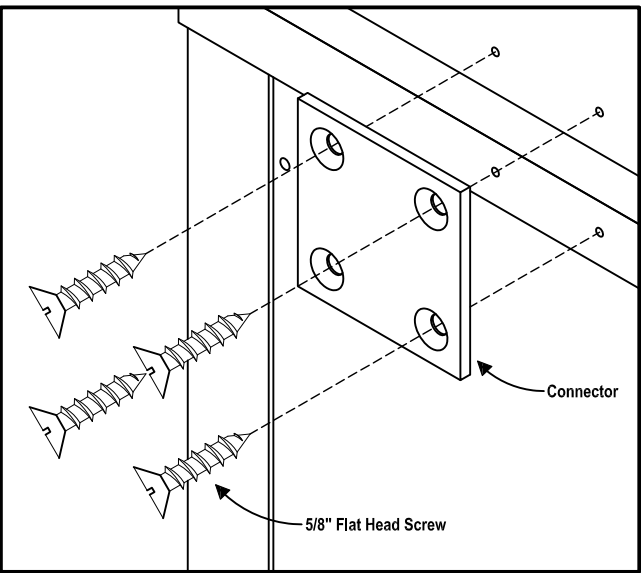
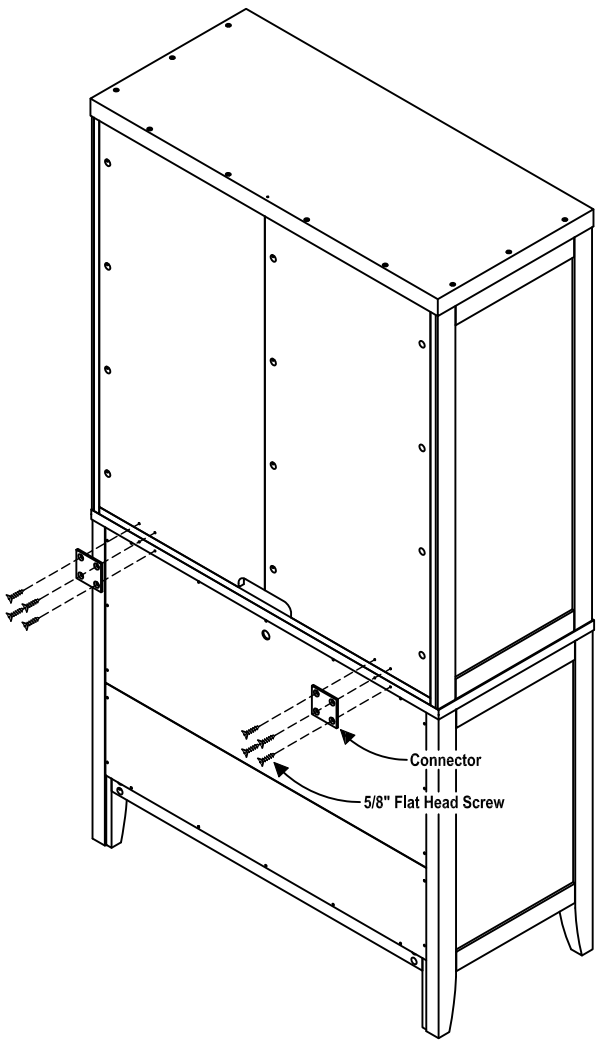

Figure 5



## ATTENTION!

To help reduce the risk of the unit tipping over, the Tipover Restraint must be installed following these instructions exactly!

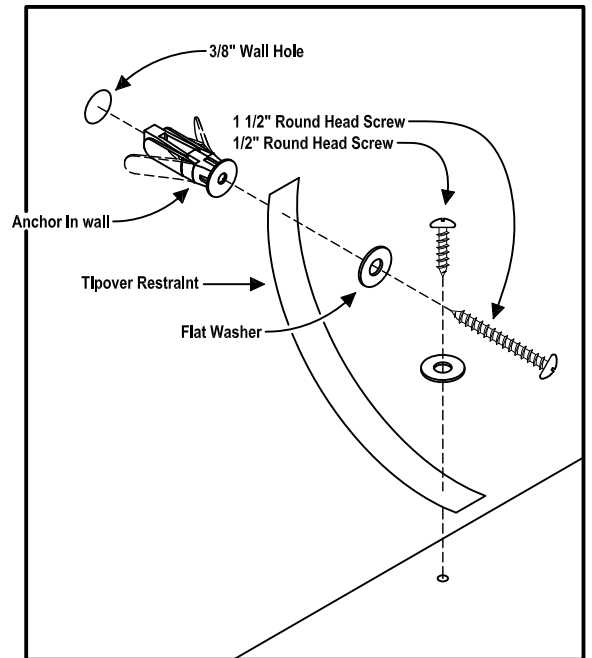
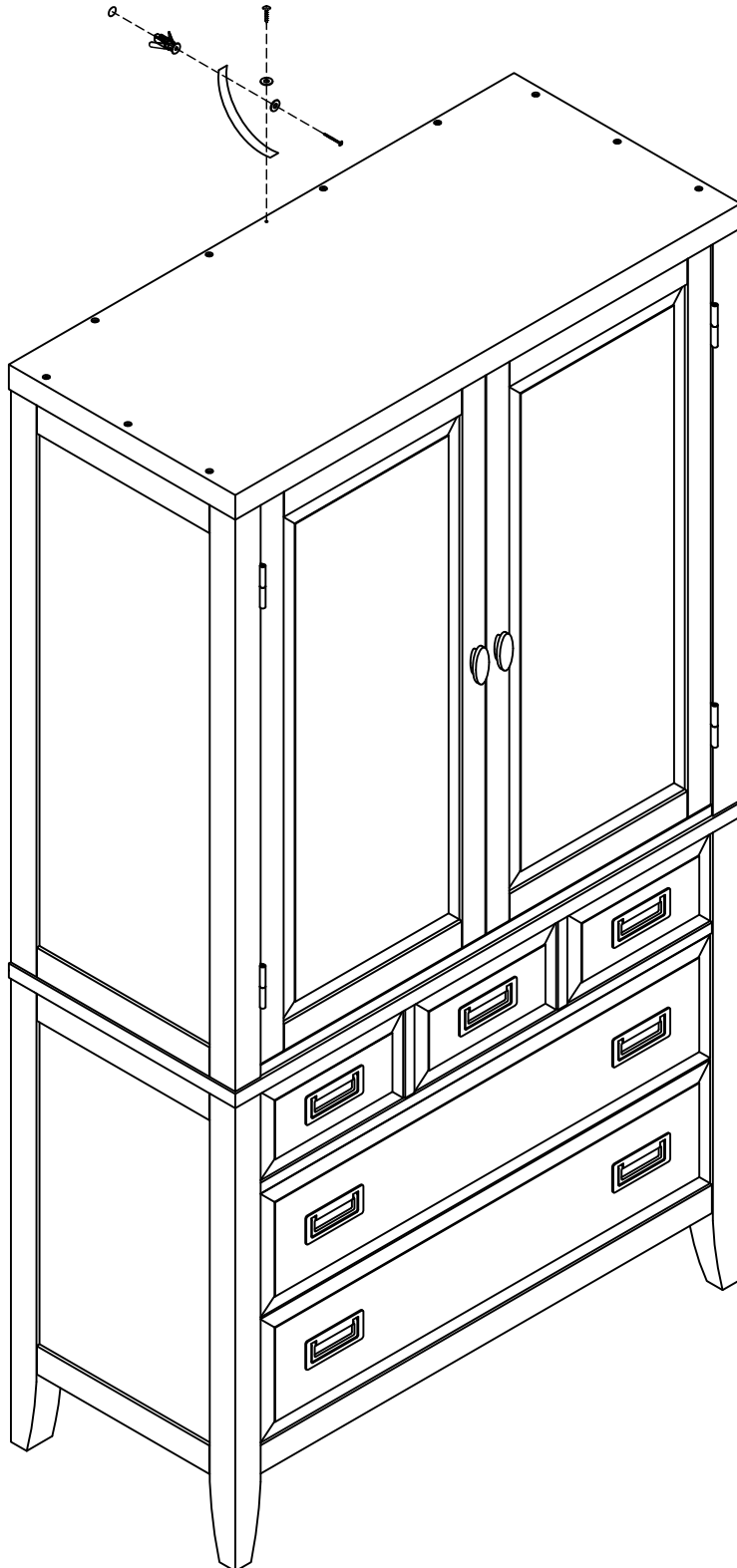

Figure 6

Place the cabinet at desired location.

Drill a 3/8" hole in wall at the appropriate location.

Insert the Anchor into the wall hole and attach Tipover Restraint to Anchor using 1 1/2" Round Head Screw and Flat Washer.

Attach Tipover Restraint at pre-drilled hole at top of unit with 1/2" Round Head Screw and Flat Washer.  
(See Figure 6)

## Assembly Instructions 8/8

### IMPORTANT NOTICE

\* If the magnetic door catches are too strong and the door difficult to open, the magnetic power can be reduced and the door made easier to open by doing the following:

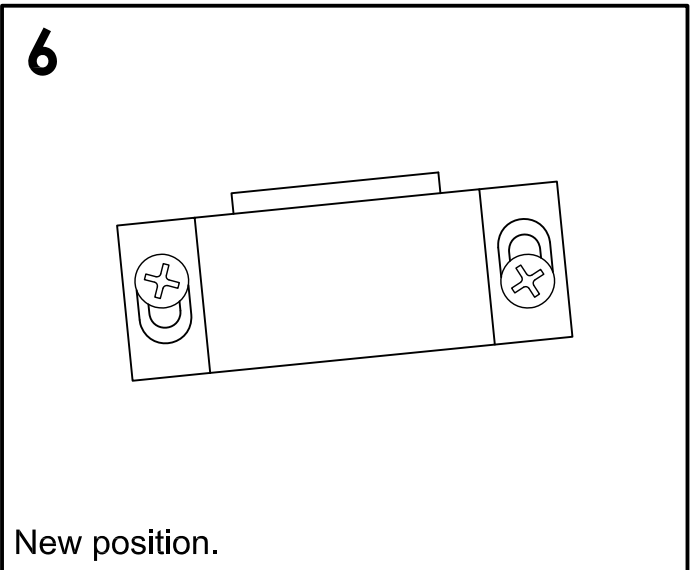
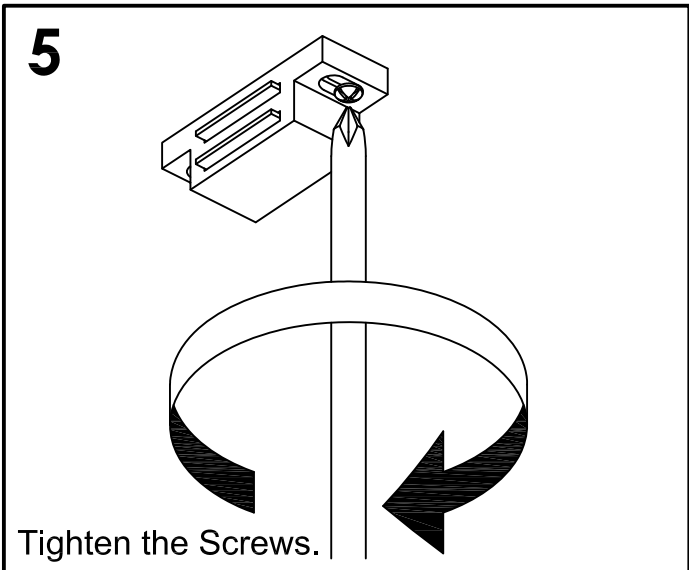
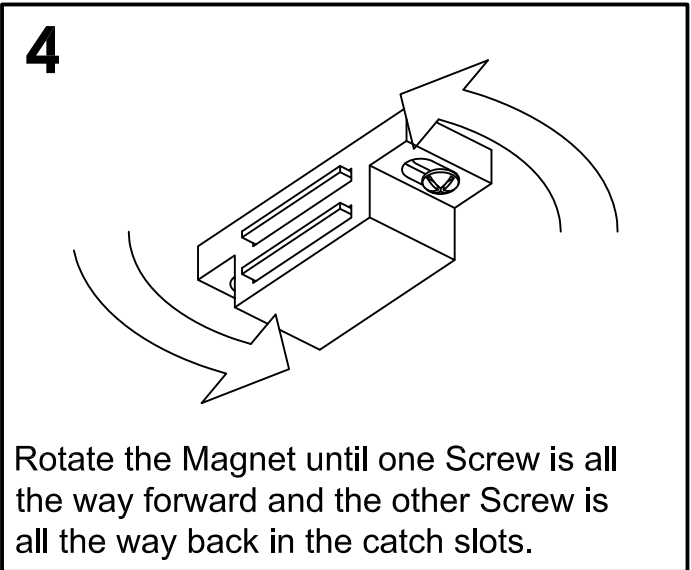
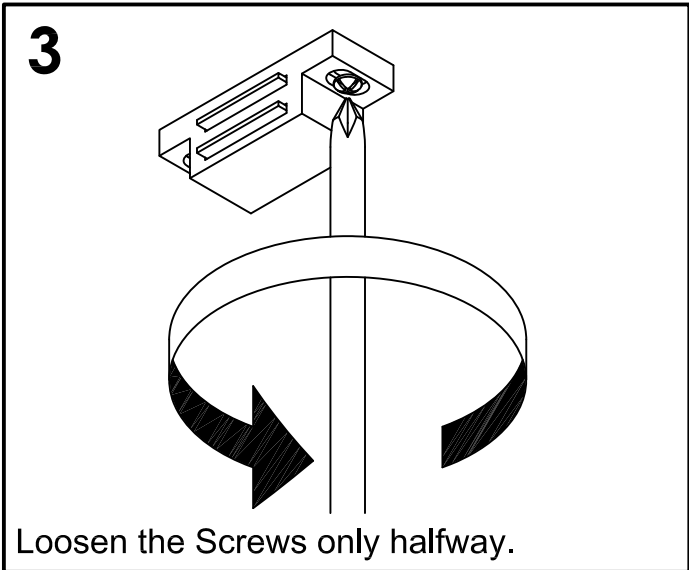
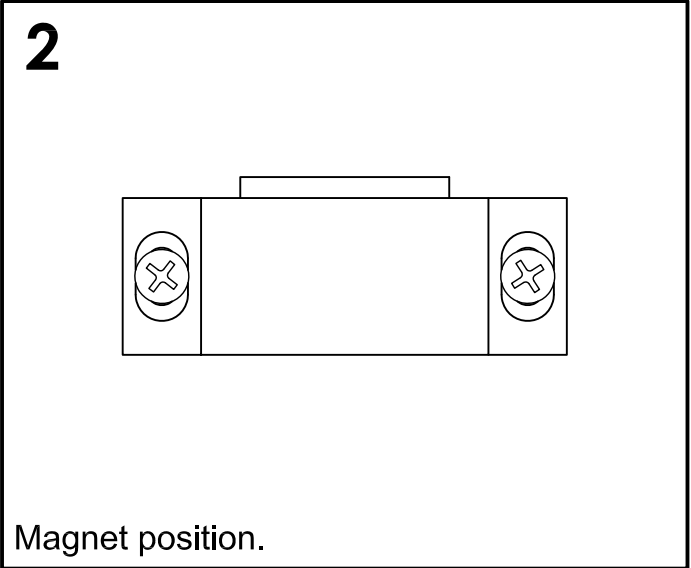
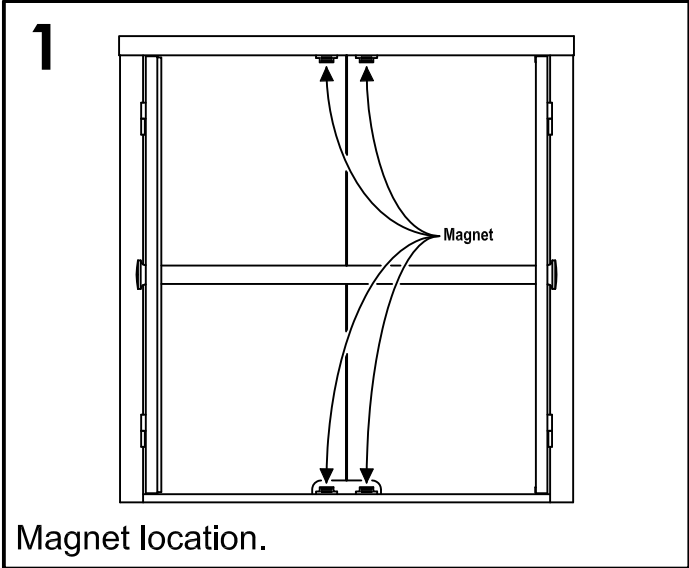



# VERY IMPORTANT !!

## CARE INSTRUCTIONS

### NEVER

USE GLASS CLEANERS ON FINISHED FURNITURE. AMMONIA WILL CHEMICALLY ATTACK THE FINISH.

### NEVER

ALLOW LIQUIDS OF ANY KIND TO REMAIN ON THE FURNITURE. ABSORPTION CAUSES PART TO WARP AND SPLIT AND FINISHES TO DELAMINATE.

DO NOT  
WRITE  
DIRECTLY  
ON  
SURFACE.



**PREVENT  
MARKING**

DO NOT  
PLACE IN  
DIRECT  
SUNLIGHT.



**PREVENT  
FADING**

DO NOT USE  
COMMERCIAL  
WAXES AND  
POLISHES.



**PREVENT  
YELLOWING**

DO NOT  
PLACE HOT  
OBJECTS  
ON SURFACE.



**PREVENT  
FINISH DAMAGE**

DO NOT  
USE  
RUBBER  
BASED  
PLACE MATS.



**PREVENT  
DISCOLORING**

## TO CLEAN

USE A SOFT CLOTH MOISTENED IN LUKEWARM SOAP AND WATER, THEN BUFF WITH A DRY CLEAN CLOTH.



Home Styles will provide replacements free of charge for missing or damaged hardware or parts within 30 days of purchase. Digital images of the defective parts may be required. If this product was not purchased from an authorized retail affiliate, Home Styles is under no obligation to provide replacement parts. Parts are not available for fully assembled items nor are parts available for sale. Replacements for missing or damaged hardware or parts may be requested at:

[www.homestyles-furniture.com/customer\\_service](http://www.homestyles-furniture.com/customer_service)

**Home Styles Consumer Assistance:** [www.homestyles-furniture.com](http://www.homestyles-furniture.com),  
[servicedesk@homestyles-furniture.com](mailto:servicedesk@homestyles-furniture.com), 888-680-7460, 877-831-0319